

FLS - 010 Plastic Flow Switch



The FLS-010 Flow Switch is a reliable in-line piston style sensor with POM (Acetal) housing, a Polypropylene piston, and a Stainless Steel spring. The Flow Switch provides an accurate yet cost effective solution for set point flow monitoring (flow or no-flow). Featuring a simple make or break signal using reed switch technology, and can be mounted vertically or horizontally.

Product Specifications:

Contact Rating (Max):	50 W
Switching Voltage (Max):	200 VDC
Breakdown Voltage (Min):	300 VDC
Switching Current (Max):	0.7 A
Contact Resistance (Max):	350 mΩ
Insulation Resistance (Max):	10 ¹⁰ Ω
Mounting Position:	Horizontal / Vertical
Operating Temperature:	0~80°C
Flow Set Point Options:	0.75 +/- 0.25 LPM 1.25 +/- 0.25 LPM 1.75 +/- 0.25 LPM
Trigger Pressure Difference:	≥ 0.25 kg/cm ²

Features:

- Sensor Integration Options
- Multiple Mounting Options
- Different Connector Options

Applications:

- HVAC
- Medical Devices
- Welding & Manufacturing



The device features G 1/2"-14 (1/2" BSPP) male threaded connections and for flexibility we offer various sensing flow rates and a choice of Barbed Hose or Coupling adapters.

For use in Hot or cold water up to 80°C. Ideal for Coolant, HVAC, welding, medical and many other industries.

Available sensing minimum flow rates of: 0.75LPM, 1.25LPM, 1.75LPM

Switch types 'Normally open' Make contact with Flow.

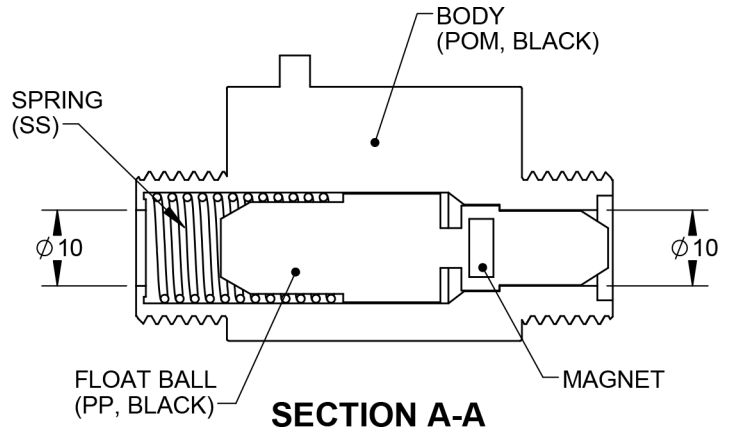
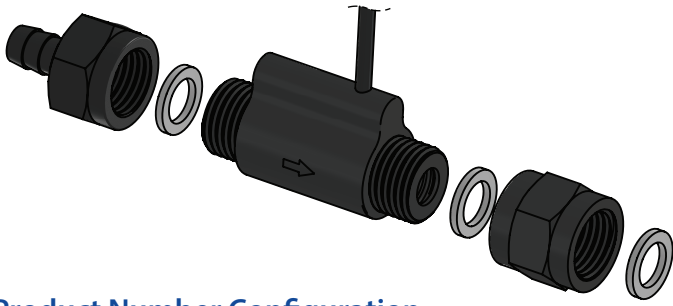

Product Number Configuration

FLS-010-XXX-X

SENSOR NUMBER

FLOW SENSE POINT

- 075 = 0.75 LPM
- 125 = 1.25 LPM
- 175 = 1.75 LPM

CONNECTORS

- BLANK = NO CONNECTORS
- 1 = 1 BARBED CONNECTOR
- 2 = 1 THREADED CONNECTOR, G1/2-14
- 2A = 1 THREADED CONNECTOR, 1/2"NPT
- 3 = 1 BARBED CONNECTOR, 1 G1/2-14 CONNECTOR
- 3A = 1 BARBED, 1 1/2"NPT CONNECTOR

4 = 2 BARBED CONNECTORS

5 = 2 THREADED CONNECTORS, G1/2-14

5A = 2 THREADED CONNECTORS, 1/2"NPT

*NOTE: EACH THREADED CONNECTOR COMES WITH 2 GASKETS. EACH BARBED CONNECTOR COMES WITH 1 GASKET

FLS-010-XXX-1 - Sensor Body

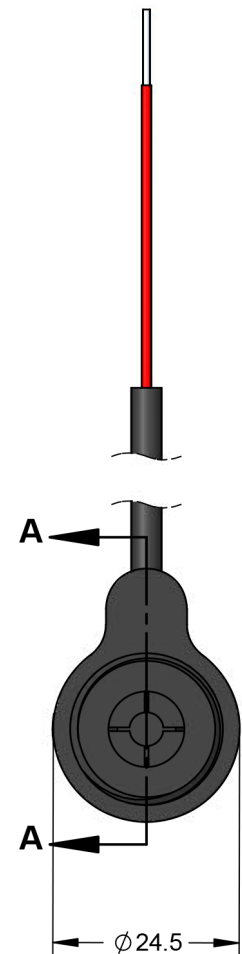
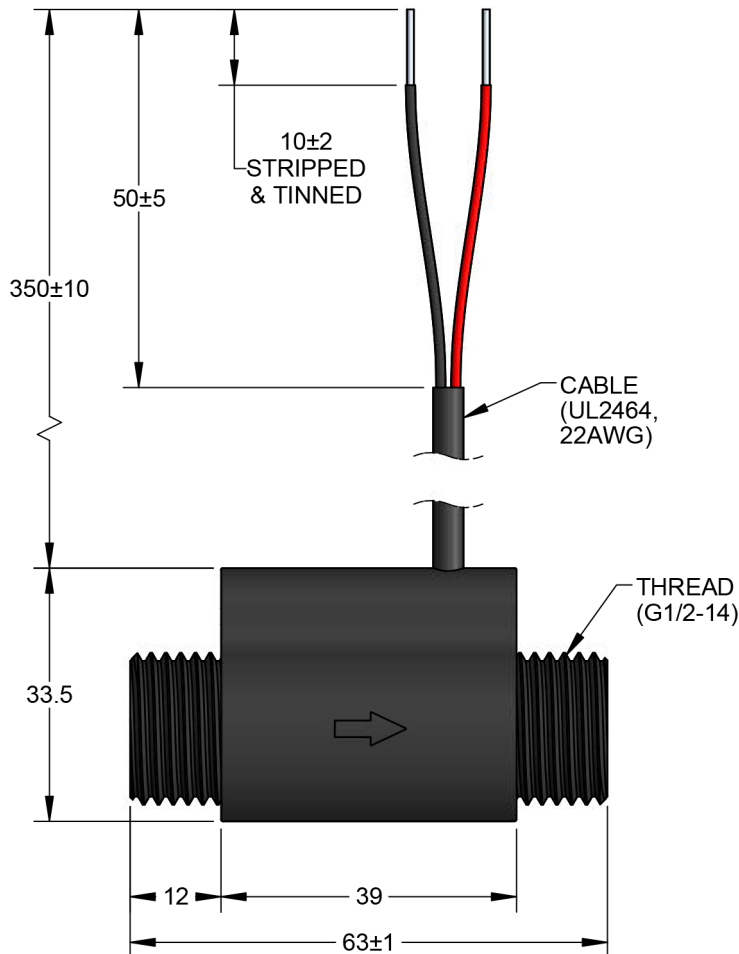

FLS-010-XXX-2: Connector: Barbed (Material: ABS/PC)

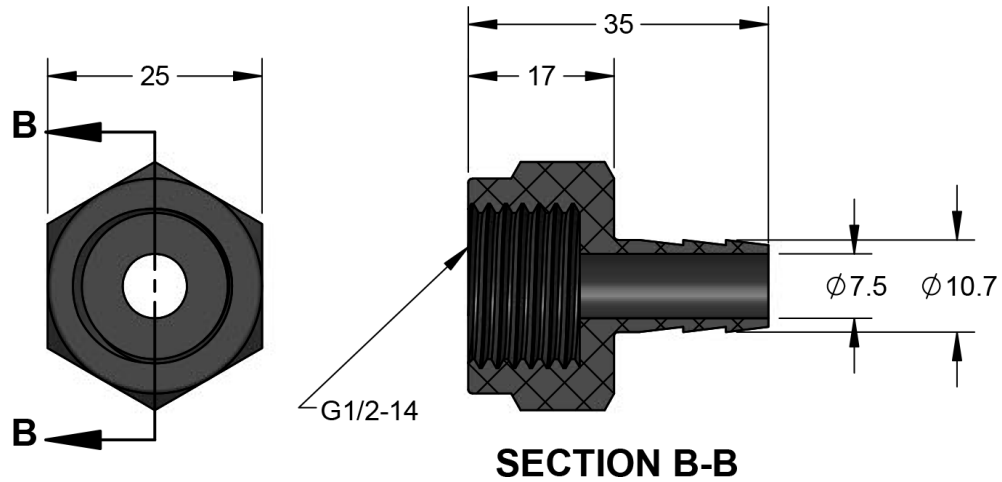

FLS-010-XXX-3: Connector: Threaded (Material: ABS/PC)

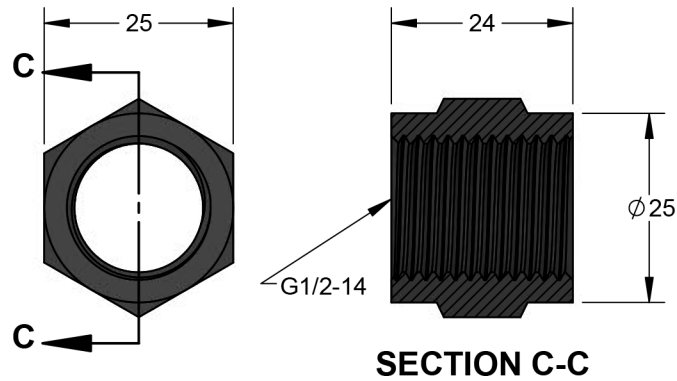

FLS-010-XXX-4: Gasket (Material: Silicone)

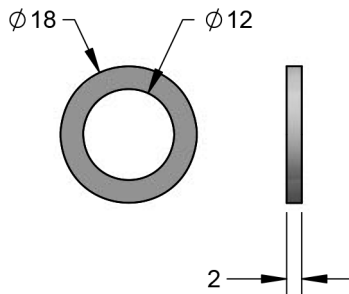

FLS-010-XXX-5: Connector, NPT (Material: PA)

