

MOD No.	REV.	DRAWN BY	DATE
—	1	JMG	04 11 08

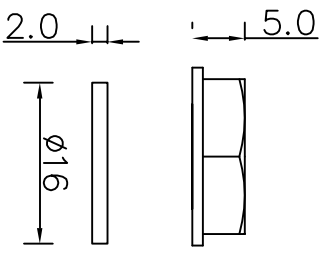

Switch Characteristic

1. Contact : **D1 = 14 mm +/- 2 mm**
2. Max Contact Rating : 50 W Res. Load
3. Max Switching Voltage : 250 Vdc
4. Min Breakdown Voltage : 750 Vdc
5. Max Switching Current : 1.0 A
6. Min Insulation Potential: 1000 Vdc
7. Max Contact Resistance : 100m Ohm
8. Min Insulation Resistance: 10^{10} Ohm
9. Electrical Life: 1×10^6 (5VDC, 10mA)

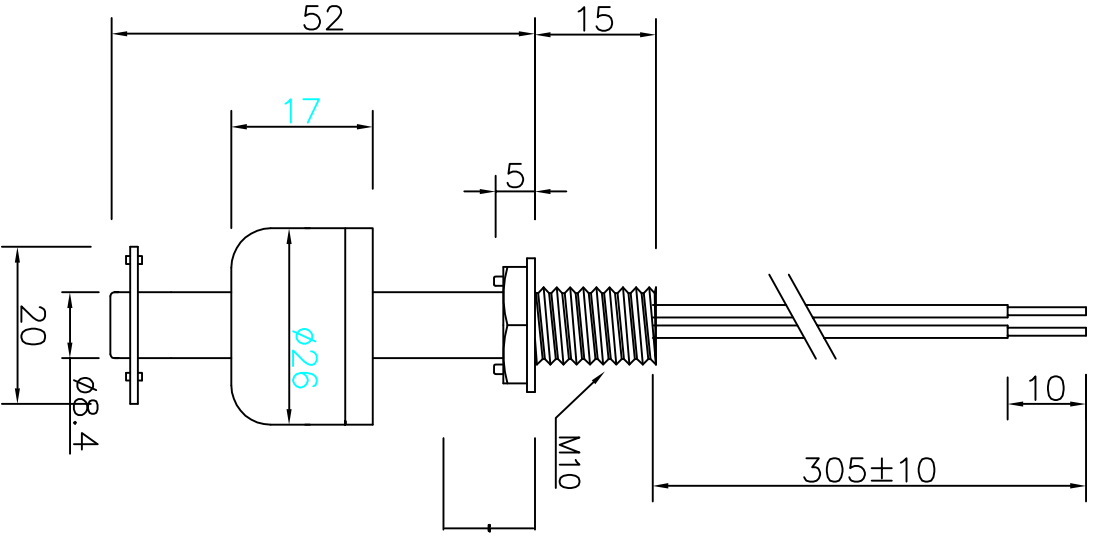

UNLESS OTHERWISE SPECIFIED:

BREAK SHARP EDGES .003-.015
 SURFACES TO BE SQUARE &/OR PARALLEL W/IN .005
 X/X = 1/64"
 X = ±.030"
 .XXX = ±.005"
 .XXXX = ±.001"
 .XX = ±.010"
 ANGLES = ±2°

BREAK SHARP EDGES .08-.4
 SURFACES TO BE SQUARE &/OR PARALLEL W/IN .127
 Xmm = ±0.5mm
 X.XXXmm = ±0.15mm ANGLES = ±2°



STRAIN MEASUREMENT DEVICES, INC.
 130 RESEARCH PARKWAY, MERIDEN, CT 06450
 TELEPHONE:(203)235-9330 FAX(203)235-3470

TITLE: FS52-0011 Normally Open			
DATE: XX/XX/XX	SCALE: NONE	DWG: JMG	CHECKED BY: XXX
DWG No. 04.11.08		USED ON:	APPRV BY: